





## Sustainable

Spaces are well integrated with and respectful of larger environmental and ecological systems.



## What makes a great place?

Great places come in many shapes and sizes, but share some common, timeless characteristics - they are comfortable, sociable, accessible, have a range of activities, respect the environment and honor the sense of place.



## Accessible

Spaces are accessible by all, served by active transportation, and are well connected with the rest of the city.





## Sociable

Spaces are welcoming, inclusive, interactive, and encourage nighttime use.

## Active

Spaces have multiple uses and activities, day and night, temporary or permanent.



## Comfort + Image

Spaces are pleasant, attractive and safe year-round, and celebrate local culture and history, such as aboriginal heritage

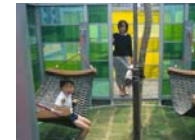

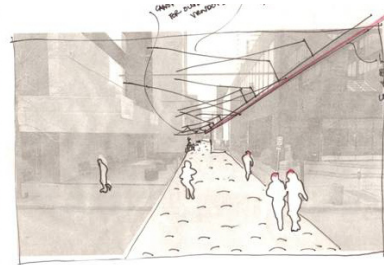
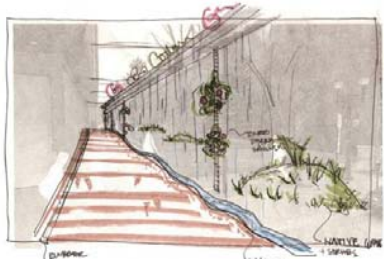

**Sheri Krug**

The intent with my images was to provide a basic infrastructure, utilizing standardized forms, in which people could add or remove items (images, plant life, sculpture, etc) as the seasons changed or as they saw fit. The alley would take on various forms and evolve organically depending upon whom was involved. Wayfinding elements such as differences in paving treatments, a water feature and/or light feature would assist in pedestrian movement. Entertainment space or "place making" space would be integrated into the design as well.

**David Holdsworth**

Reconfiguring the park and opening up the side of the Icon tower helps ensure the park becomes a focal point for activity. A desire to respect the historic setting by use of appropriate materials and richness in detail, whether traditional or contemporary, should be encouraged.

Possibilities

A group of volunteer designers, citizens and students have spent some time imagining how the themes of sociability, activity, comfort, sustainability and accessibility might be realized in this project.

The group has embraced the notion that the alley can redevelop over time through both temporary and permanent interventions. This organic growth can best be achieved through the introduction of an architectural infrastructure upon which the community can build on.

**Alley of Light** is the name this group has suggested for this endeavor. The name speaks to the opportunity to use light to reinvigorate the alley year-round, both day and night.

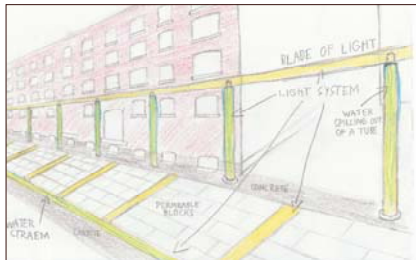

**Daryl Randa**

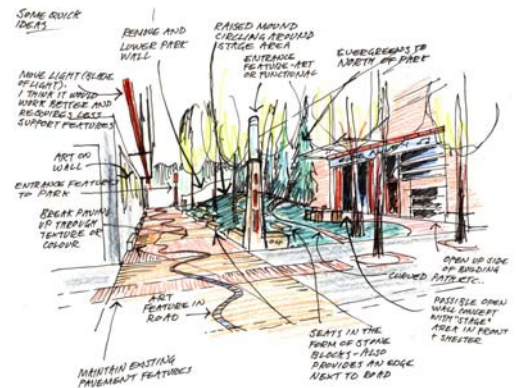

**Peter Spearey**

I imagine a network of LEDs that responds to temperature, sound and movement, to create a varied rhythm of light and colour in the alley.

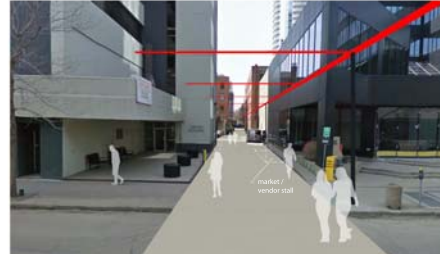

**Shafraaz Kaba**

The Blade of Light concept uses a single, bold structure to carry a lighting fixture and infrastructure pipe down the alley. The intent was to provide basic lighting and services [power, water, drainage] to enable many uses and functions to occur in the alley. This also leaves the space open to interpretation and many different possible uses.

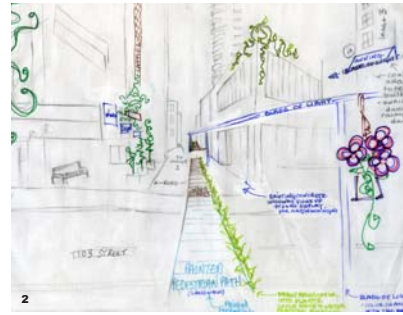
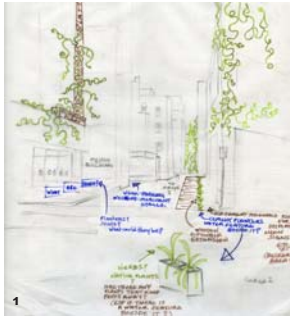

Possibilities

**Kira Hunt**

1 / Lattices and planter boxes could be introduced, allowing for green growth along the tops of buildings. The existing concrete walk could be widened (here shown with a wood surface and a line of small plants - or water features). Plants incorporated into the alleyway could have specific uses: keep insects away, add colour / texture (year-round), add fragrance, etc.

2 / This image shows a painted crosswalk as an entrance to the alley from 103 street. This could both raise awareness of the new use of space, and create a clear (and safer) point of crossing. A light feature could also be used to support awnings, or to hang planters in the summer.

3 / Artwork and fresh paint to rejuvenate building surfaces and create interest in a small nook. The back doors of the shops along here could be opened up during the farmers market and special events. Ramps could be added for roll out shelving and to increase accessibility. This multilevel area might also make an interesting performance or display space.

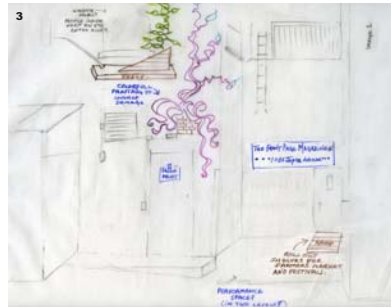

**Tyler Dixon**

Increased porosity of ground floor retail into a secondary, vibrant path parallel to Jasper Avenue has the potential to develop a new 'destination' devoted to pedestrian activities. Sculptural and historic lighting culminate to create a variety of safe, interesting areas scaled to the human body rather than the speed and bulk of vehicular travel.